



2



1b



3





1a

- 1 a. 36X22 Lexington Vanity in Cinnamon on Cherry with Post Legs
b. 36x30 Lexington Medicine Cabinet in Cinnamon on Cherry
- 2 36X22 Lexington Vanity in Cinnamon on Cherry
- 3 36X22 Lexington Vanity in Cinnamon on Cherry with Chippendale Legs

Lexington

BASE OPTIONS

When ordering a Base Option other than the *Post Leg* (LEXP), replace LEXP in model with, LEKK for *Kick Base* or LEXC for *Chippendale Leg*.

 Post Leg LEXP	 Kick Base LEKK Deduct 1 3/4" from the height of the selected item)	 Chippendale Leg LEXC Deduct 1" from the height of the selected item)				
List Prices. (Shown Below)	DEDUCT FROM LIST PRICE			ADD TO LIST PRICE		
	Oak	Maple	Cherry	Oak	Maple	Cherry
	\$100	\$125	\$150	\$340	\$375	\$390

TO ORDER, SPECIFY THE FOLLOWING:

- Model:** See "Model" column on price list below.
- Door Style:** { V: Veneer } - { R: Raised Panel } - { S: Shaker } - { B: Beaded } (see page E at the beginning of the catalog).
- Wood:** { O: Oak } - { M: Maple } - { C: Cherry }
- Color:** (See page D at the beginning of the catalog)

Example: **LEKKV4822-3D(L) V M NA**

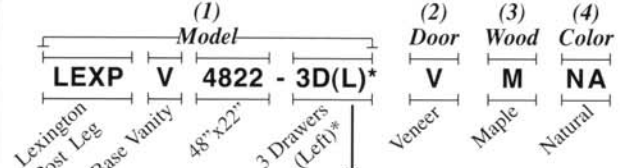

*For Right Drawers replace (L) with (R).

Lexington Post Leg (LEXP)

Ref	Model	Size in inches (W x D)	Oak			Maple			Cherry		
			Veneer	Raised Panel	Shaker	Beaded	Veneer	Raised Panel	Shaker	Beaded	Veneer

Add 1 1/2" to the width for base molding

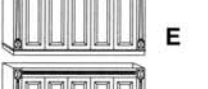
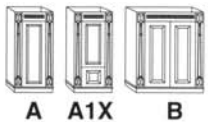

V: Base Vanities - 34 1/4" Height											
A	LEXPV1917 (L or R)	17 3/4 x 16 1/2	559	717	759	607	779	825	660	847	897
A1X	LEXPV1917-BD (L or R)	17 3/4 x 16 1/2	651	809	851	699	871	917	752	939	989
B	LEXPV2422 (or 19)	23 1/2 x 21 1/4 or 18 1/2	732	940	1024	796	1021	1113	865	1110	1210
B1X	LEXPV2422-BD (or 19)	23 1/2 x 21 1/4 or 18 1/2	841	1049	1133	905	1130	1222	974	1219	1319
B	LEXPV3022 (or 19)	29 1/2 x 21 1/4 or 18 1/2	774	1035	1120	842	1125	1217	915	1223	1323
B1X	LEXPV3022-BD (or 19)	29 1/2 x 21 1/4 or 18 1/2	892	1153	1238	960	1243	1335	1033	1341	1441
B	LEXPV3622	35 1/2 x 21 1/4	867	1179	1264	942	1282	1374	1024	1393	1493
B1X	LEXPV3622-BD	35 1/2 x 21 1/4	995	1307	1392	1070	1410	1502	1152	1521	1621
B3	LEXPV3622-3D(L) or (R)*	35 1/2 x 21 1/4	1137	1450	1535	1236	1576	1668	1343	1713	1813
C	LEXPV4222	41 1/2 x 21 1/4	873	1224	1309	949	1330	1422	1032	1446	1546
C2X	LEXPV4222-BD	41 1/2 x 21 1/4	1090	1441	1526	1166	1547	1639	1249	1663	1763
B3	LEXPV4222-3D(L) or (R)*	41 1/2 x 21 1/4	1134	1485	1569	1233	1614	1706	1340	1754	1854
D	LEXPV4822	47 1/2 x 21 1/4	925	1310	1416	1006	1424	1539	1093	1548	1673
D3X	LEXPV4822-BD	47 1/2 x 21 1/4	1232	1617	1723	1313	1731	1846	1400	1855	1980
C3	LEXPV4822-3D(L) or (R)*	47 1/2 x 21 1/4	1175	1560	1666	1277	1696	1811	1388	1843	1968
B6	LEXPV4822-6D	47 1/2 x 21 1/4	1425	1810	1916	1549	1968	2083	1684	2139	2264
D	LEXPV5422	53 1/2 x 21 1/4	966	1399	1505	1050	1521	1636	1141	1653	1778
D3X	LEXPV5422-BD	53 1/2 x 21 1/4	1234	1667	1773	1341	1812	1927	1458	1970	2095
C3	LEXPV5422-3D(L) or (R)*	53 1/2 x 21 1/4	1215	1649	1755	1321	1792	1907	1436	1948	2073
B6	LEXPV5422-6D	53 1/2 x 21 1/4	1466	1899	2005	1593	2064	2179	1732	2244	2369
D	LEXPV6022	59 1/2 x 21 1/4	1006	1487	1593	1093	1616	1731	1188	1757	1882
D3X	LEXPV6022-BD	59 1/2 x 21 1/4	1282	1764	1870	1394	1917	2032	1515	2084	2209
C3	LEXPV6022-3D(L) or (R)*	59 1/2 x 21 1/4	1270	1752	1858	1381	1904	2019	1501	2070	2195
D3C	LEXPV6022-3DC	59 1/2 x 21 1/4	1270	1752	1858	1381	1904	2019	1501	2070	2195
B6	LEXPV6022-6D	59 1/2 x 21 1/4	1536	2018	2124	1670	2193	2308	1815	2384	2509
D	LEXPV6622	65 1/2 x 21 1/4	1114	1644	1750	1211	1787	1902	1316	1942	2067
D3X	LEXPV6622-BD	65 1/2 x 21 1/4	1399	1929	2035	1521	2097	2212	1653	2279	2404
C3	LEXPV6622-3D(L) or (R)*	65 1/2 x 21 1/4	1391	1921	2027	1512	2088	2203	1644	2270	2395
D3C	LEXPV6622-3DC	65 1/2 x 21 1/4	1391	1921	2027	1512	2088	2203	1644	2270	2395
B6	LEXPV6622-6D	65 1/2 x 21 1/4	1669	2200	2306	1814	2391	2506	1972	2599	2724
E	LEXPV7222	71 1/2 x 21 1/4	1154	1732	1838	1254	1882	1997	1363	2046	2171
E3X	LEXPV7222-BD	72 1/2 x 21 1/4	1908	2119	2246	2074	2304	2442	2254	2504	2654
D3C	LEXPV7222-3DC	71 1/2 x 21 1/4	1431	2009	2115	1556	2184	2299	1691	2374	2499

Lexington Post Leg (LEXP)

Ref	Model	Size in inches (W x D)	Oak			Maple			Cherry		
			Veneer	Raised Panel Shaker	Beaded	Veneer	Raised Panel Shaker	Beaded	Veneer	Raised Panel Shaker	Beaded
S: Single Base Vanities - 34 1/4" Height											
FA1	LEXPS1522-1D or 19	14 3/4 x 21 1/4 or 18 1/2	777	897	940	845	975	1021	918	1060	1110
F3	LEXPS1522-3D or 19	14 3/4 x 21 1/4 or 18 1/2	1043	1163	1205	1133	1264	1310	1232	1374	1424
FA1	LEXPS1822-1D or 19	17 3/4 x 21 1/4 or 18 1/2	797	941	984	867	1023	1069	942	1112	1162
F3	LEXPS1822-3D or 19	17 3/4 x 21 1/4 or 18 1/2	1074	1219	1261	1167	1325	1371	1269	1440	1490
FB1	LEXPS2422-1D or 19	23 1/2 x 21 1/4 or 18 1/2	836	1029	1072	909	1119	1165	988	1216	1266
F3	LEXPS2422-3D or 19	23 1/2 x 21 1/4 or 18 1/2	1138	1331	1374	1237	1447	1493	1345	1573	1623

Add 1 1/2" to the width for base molding

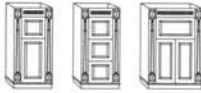

FA1 F3 FB1

Add 3/4" to the width for base molding



WA WA1 W3

W: Wing Base Vanities - 34 1/4" Height - {Specify Left (L) or Right (R)}											
WA	LEXPW1219(L) or (R)	12 x 18 1/2	557	635	668	606	690	727	659	750	790
WA1	LEXPW1219-1D(L) or (R)	12 x 18 1/2	697	794	836	758	863	909	824	938	988
W3	LEXPW1219-3D(L) or (R)	12 x 18 1/2	948	1044	1087	1030	1135	1181	1120	1234	1284
WA	LEXPW1519(L) or (R)	14 3/4 x 18 1/2	574	670	704	624	728	765	678	792	832
WA1	LEXPW1519-1D(L) or (R)	14 3/4 x 18 1/2	718	838	880	780	911	957	848	990	1040
W3	LEXPW1519-3D(L) or (R)	14 3/4 x 18 1/2	983	1108	1150	1068	1204	1250	1161	1309	1359
WA	LEXPW1819(L) or (R)	17 3/4 x 18 1/2	590	705	739	641	767	804	697	833	873
WA1	LEXPW1819-1D(L) or (R)	17 3/4 x 18 1/2	738	882	924	802	959	1005	872	1042	1092
W3	LEXPW1819-3D(L) or (R)	17 3/4 x 18 1/2	1015	1160	1202	1103	1260	1306	1199	1370	1420

Add 1 1/2" to the width for base molding

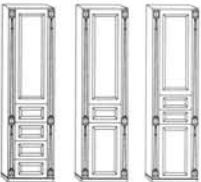

TA4 TB1 TB2



TB4 TD1 TD2

TC: Tall Cabinets - 80" Height											
TB1	LEXPTC1515-1D	14 3/4 x 15	1430	1686	1793	1554	1810	1949	1683	1992	2119
TB2	LEXPTC1515-2D	14 3/4 x 15	1581	1761	1869	1715	1914	2031	1867	2030	2208
TA4	LEXPTC1515-4D	14 3/4 x 15	1730	1911	2013	1887	2077	2194	2046	2258	2385
TB1	LEXPTC1522-1D or 19	14 3/4 x 21 1/4 or 18 1/2	1683	1984	2111	1829	2156	2294	1988	2344	2494
TB2	LEXPTC1522-2D or 19	14 3/4 x 21 1/4 or 18 1/2	1860	2072	2199	2021	2252	2390	2197	2448	2598
TA4	LEXPTC1522-4D or 19	14 3/4 x 21 1/4 or 18 1/2	2036	2249	2376	2214	2444	2582	2406	2657	2807
TB1	LEXPTC1815-1D	17 3/4 x 15	1469	1781	1889	1598	1936	2053	1736	2103	2232
TB2	LEXPTC1815-2D	17 3/4 x 15	1555	1857	1965	1690	2018	2136	1840	2193	2321
TA4	LEXPTC1815-4D	17 3/4 x 15	1784	2017	2132	1939	2193	2310	2108	2213	2510
TB1	LEXPTC1822-1D or 19	17 3/4 x 21 1/4 or 18 1/2	1729	2096	2223	1880	2278	2416	2043	2476	2626
TB2	LEXPTC1822-2D or 19	17 3/4 x 21 1/4 or 18 1/2	1830	2185	2312	1989	2375	2513	2162	2581	2731
TA4	LEXPTC1822-4D or 19	17 3/4 x 21 1/4 or 18 1/2	2099	2373	2500	2282	2580	2718	2480	2804	2954
TD1	LEXPTC2415-1D	23 1/2 x 15	1549	1972	2077	1684	2143	2261	1830	2329	2457
TD2	LEXPTC2415-2D	23 1/2 x 15	1720	2057	2165	1870	2236	2353	2032	2431	2558
TB4	LEXPTC2415-4D	23 1/2 x 15	1891	2228	2836	2056	2422	2539	2234	2633	2760
TD1	LEXPTC2422-1D or 19	23 1/2 x 21 1/4 or 18 1/2	1823	2320	2447	1982	2522	2660	2154	2741	2891
TD2	LEXPTC2422-2D or 19	23 1/2 x 21 1/4 or 18 1/2	2024	2421	2548	2200	2631	2769	2391	2860	3010
TB4	LEXPTC2422-4D or 19	23 1/2 x 21 1/4 or 18 1/2	2225	2622	2749	2419	2850	2988	2629	3098	3248

Add 1 1/2" to the width for base molding



SA1 SA2

ST: Semi Tall Cabinets - 48" Height											
SA1	LEXPST1515-1D	14 3/4 x 15	1151	1212	1276	1343	1414	1489	1567	1650	1782
SA1	LEXPST1519-1D	14 3/4 x 18 1/2	1280	1347	1418	1493	1572	1655	1742	1834	1925
SA2	LEXPST1515-2D	14 3/4 x 15	1246	1312	1381	1453	1530	1611	1751	1904	2057
SA2	LEXPST1519-2D	14 3/4 x 18 1/2	1444	1520	1601	1635	1774	1868	1966	2070	2235
SA1	LEXPST1815-1D	17 3/4 x 15	1234	1299	1368	1440	1516	1596	1630	1769	1910
SA1	LEXPST1819-1D	17 3/4 x 18 1/2	3442	1413	1487	1566	1648	1735	1826	1923	1973
SA2	LEXPST1815-2D	17 3/4 x 15	1399	1472	1550	1632	1718	1808	1903	2004	2164
SA2	LEXPST1819-2D	17 3/4 x 18 1/2	1521	1601	1685	1774	1868	1966	2070	2179	2353

Lexington Post Leg (LEXP)



Ref	Model	Size in inches (W x D)	Oak			Maple			Cherry		
			Veneer	Raised Panel	Shaker	Veneer	Raised Panel	Shaker	Veneer	Raised Panel	Shaker
COT: Cabinets Over Toilet - 32" Height											
KAF	LEXCOT-FD 18	17 3/4 x 8	498	624	708	541	678	770	588	737	837
KAO	LEXCOT-OS 18	17 3/4 x 8	510	688	773	554	748	840	602	813	913
KBF	LEXCOT-FD 24	23 1/2 x 8	532	667	757	578	725	823	629	788	895
KBO	LEXCOT-OS 24	23 1/2 x 8	547	736	821	592	800	898	644	869	976

CM: Crown Molding - 2 1/4" Height



Ref	Model	Size in inches (W x D)	Tall Cabinet			C.O.T.		
			Oak	Maple	Cherry	Oak	Maple	Cherry
CM	LEXCM12(TC) or (COT)	(Crown molding adds	220	231	243	NA	NA	NA
CM	LEXCM15(TC) or (COT)	4 3/4" to the width of the	240	252	265	NA	NA	NA
CM	LEXCM18(TC) or (COT)	selected item, and	250	263	276	185	198	210
CM	LEXCM24(TC) or (COT)	2 3/8" to the depth.)	260	273	287	198	210	222

MC: Surface Medicine Cabinets - 30" Height

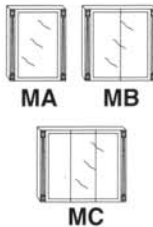

Ref	Model	Size in inches (W x D)	Oak		Maple		Cherry	
			Plain	Crown	Plain	Crown	Plain	Crown
MA	LEXMC2430	24 x 5 3/4	678	876	746	956	895	1117
MB	LEXMC3030	30 x 5 3/4	798	1008	877	1099	1053	1288
MC	LEXMC3630	36 x 5 3/4	1038	1260	1142	1377	1370	1617
MC	LEXMC4230	42 x 5 3/4	1358	1593	1493	1740	1792	2051
MC	LEXMC4830	48 x 5 3/4	1451	1698	1596	1855	1915	2187
MC	LEXMC5430	54 x 5 3/4	1523	1782	1675	1947	2010	2296

WM: Wall Mirrors - 30" Height



Ref	Model	Size in inches (W x H)	Oak		Maple		Cherry	
			Plain	Crown	Plain	Crown	Plain	Crown
M	LEXWM2430	24 x 30	506	676	559	717	671	837
M	LEXWM3030	30 x 30	598	885	657	915	789	975
M	LEXWM3630	36 x 30	778	985	856	1032	1027	1170
M	LEXWM4230	42 x 30	1018	1194	1098	1305	1344	1475
M	LEXWM4830	48 x 30	1088	1296	1198	1415	1436	1690

LB: Surface Light Bars - 6" Height



Ref	Model	Size in inches (W x D)	Oak		Maple		Cherry	
			Plain	Crown	Plain	Crown	Plain	Crown
L3	LEXLB24	24 x 5 3/4	394	592	433	643	519	741
L4	LEXLB30	30 x 5 3/4	410	620	451	673	541	776
L5	LEXLB36	36 x 5 3/4	455	677	500	735	600	847
L6	LEXLB42	42 x 5 3/4	501	736	551	798	661	920
L6	LEXLB48	48 x 5 3/4	617	864	678	937	814	1086
L6	LEXLB54	54 x 5 3/4	647	907	707	983	854	1151

GL: Gooseneck Light Bars - 6" Height

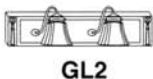

Ref	Model	Size in inches (W x D)	Oak		Maple		Cherry	
			Plain	Crown	Plain	Crown	Plain	Crown
GL2	LEXGL24	24 x 5 3/4	492	592	541	641	648	748
GL3	LEXGL30	30 x 5 3/4	512	612	563	663	676	776
GL3	LEXGL36	36 x 5 3/4	568	668	625	725	750	850
GL4	LEXGL42	42 x 5 3/4	626	726	688	788	820	920
GL5	LEXGL48	48 x 5 3/4	771	871	847	947	970	1170
GL5	LEXGL54	54 x 5 3/4	809	914	889	994	1018	1228

DIMENSIONS

(W) Width, (D) Depth

Medicine Cabinets & Wall Mirrors - 30" Height Ref: M

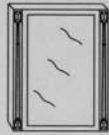

MA

W: 23½"
D: 5¾"

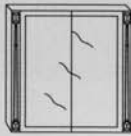

MB

W: 29½"
D: 5¾"

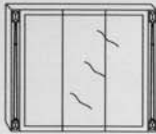

MC

W: 35½", 41½", 47½", 53½"
D: 5¾"



M

W: 24", 30", 36", 42", 48", 54"
H: 30"

Cabinets Over Toilet - 32" Height Ref: K

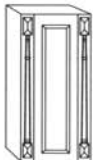

KAF

W: 17¾"
D: 8"

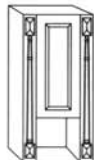

KAO

W: 17¾"
D: 8"

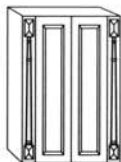

KBF

W: 23½"
D: 8"

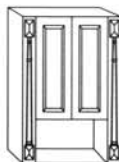

KBO

W: 23½"
D: 8"

Semi Tall Cabinets - 48" Height Ref: S

*Add 1 1/2" to the width for base molding

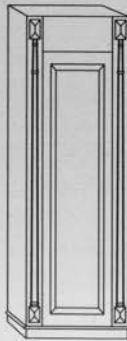

SA1

W: 14¾", 17¾"
D: 15", 18½"

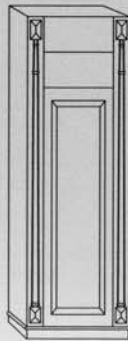

SA2

W: 14¾", 17¾"
D: 15", 18½"

Crown Moldings - 2¼" Height Ref: CM



CM

W: Will match your cabinet size
D: Will match your cabinet size

Lights - 6" Height Ref: L



L4

W: 24"(3*) - 30"(4*) - 36"(5*) - 42"(6*) - 48"(6*) - 54"(6*)
D: 5¾"

*Indicates Number of Lights

Gooseneck Light Bars Ref: GL



GL2

W: 24"(2*) - 30"(3*) - 36"(3*) - 42"(4*) - 48"(5*) - 54"(5*)
D: 5¾"

*Indicates Number of Lights

Tall Cabinets - 80" Height Ref: T

*Add 1 1/2" to the width for base molding



TA4

W: 14¾", 17¾"
D: 15", 18½", 21¼"

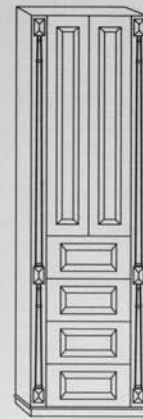

TB4

W: 23½"
D: 15", 18½", 21¼"



TB1

W: 14¾", 17¾"
D: 15", 18½", 21¼"

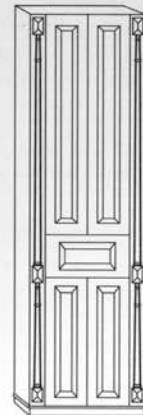

TD1

W: 23½"
D: 15", 18½", 21¼"



TB2

W: 14¾", 17¾"
D: 15", 18½", 21¼"

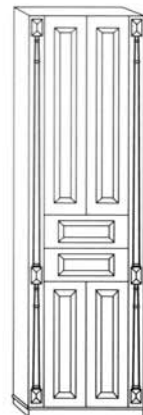

TD2

W: 23½"
D: 15", 18½", 21¼"

DIMENSIONS

(W) Width, (D) Depth

Base Vanities - 34 1/4" Height Ref: A, B, C, D, E

*Add 1 1/2" to the width for base molding

Base Vanities With Doors Only



A

W: 17 3/4"
D: 16 1/4"

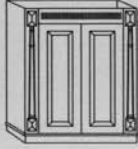

B

W: 23 1/2", 29 1/2", 35 1/2"
D: 21 1/4", 18 1/2"

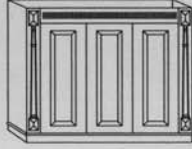

C

W: 41 1/2"
D: 21 1/4"

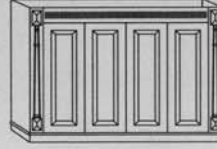

D

W: 47 1/2", 53 1/2", 59 1/2", 65 1/2"
D: 21 1/4"

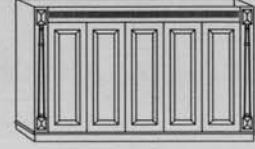

E

W: 71 1/2"
D: 21 1/4"

Base Vanities With Doors And Bottom Drawers

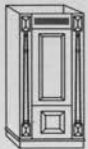

A1X

W: 17 3/4"
D: 16 1/4"

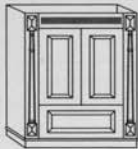

B1X

W: 23 1/2", 29 1/2", 35 1/2"
D: 21 1/4", 18 1/2"

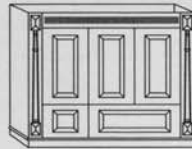

C2X

W: 41 1/2"
D: 21 1/4"



D3X

W: 47 1/2", 53 1/2", 59 1/2", 65 1/2"
D: 21 1/4"

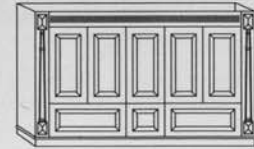

E3X

W: 71 1/2"
D: 21 1/4"

Base Vanities With Doors And Drawers (Left, Right Or Center)

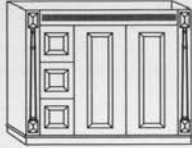

B3

W: 35 1/2", 41 1/2"
D: 21 1/4"

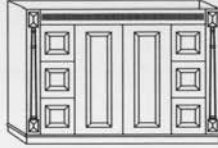

B6

W: 47 1/2", 53 1/2", 59 1/2", 65 1/2"
D: 21 1/4"



C3

W: 47 1/2", 53 1/2", 59 1/2", 65 1/2"
D: 21 1/4"



D3C

W: 59 1/2", 65 1/2", 71 1/2"
D: 21 1/4"

Single Base Cabinets - 34 1/4" Height Ref: F

*Add 1 1/2" to the width for base molding

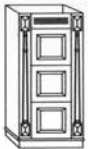

F3

W: 14 3/4", 17 3/4", 23 1/2"
D: 18 1/2", 21 1/4"

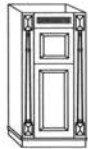

FA1

W: 14 3/4", 17 3/4"
D: 18 1/2", 21 1/4"



FB1

W: 23 1/2"
D: 18 1/2", 21 1/4"

Wing Base Cabinets - 34 1/4" Height Ref: W

*Add 3/4" to the width for base molding

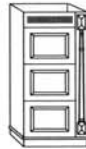

L&R

W3

W: 12", 14 3/4", 17 3/4"
D: 18 1/2"



L&R

WA1

W: 12", 14 3/4", 17 3/4"
D: 18 1/2"



L&R

WA

W: 12", 14 3/4", 17 3/4"
D: 18 1/2"



New York Vanity: 1019 Irving Avenue • Ridgewood, NY 11385
Tel.: 718-417-1010 • Fax: 718-386-3045 • www.nyvanity.com • info@nyvanity.com