

# Premier Personal Design Options - Crown, Doors, Mirrored Cabinets & Lights

Bedford (B) with Shaker (S) door graphics are shown below.

Vanity tops are shown but are not included in the price.

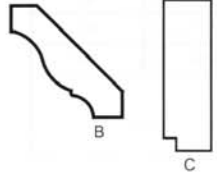

18" Ashford with Prestige wood panel option.



48" Heirloom Breakfront Cabinet with 12" side cabinets with Shaker wood panel option.



## Personal Design Option Ordering Information

Customize your Premier cabinetry with these Personal Design Options and other options listed in the Premier Collections section. Cabinets with Personal Design Options are produced in the same quick cycle as standard cabinets.

Add the Custom Option Add-on Price to the desired standard cabinet list price and specify the custom option when ordering. Due to the custom nature of these options, **cabinetry with options on this page (and throughout our price lists) cannot be returned. Option does not count as a piece for quantity discounts. Add-on Price for glaze does not apply to options.**

Ref	Description	Custom Option Add-on Price																								
<b>Carved On-Lay Option</b>																										
A	Carved On-lay option on pediment, mirrored cabinet (with no light option), framed mirror cabinet or on vanity false drawer front. Carved On-Lay is real wood that is carved rather than embossed/pressed wood. Specify the model the carved on-lay is to be applied to (some restrictions apply). Available in Cherry, Maple and Oak woods. For Hickory we will substitute the Oak Carved On-Lay. The Carved On-Lay is too large to fit on 5-piece or 1 1/8" Ogee Option profile false drawer fronts. Not available on 21" Tall Framed Mirrored Cabinet Models due to width of on-lay. Carved On-lay size 16"L x 3 3/4" H. Actual carvings will vary slightly.	237																								
<b>Crown Molding Style Change Option</b>																										
	This option is available on all items with standard crown molding. Crown molding types are: Traditional Style, Beveled and Contemporary Style. The option allows you to change the look of the crown molding from your chosen collection.	0																								
B	Traditional Style Crown Molding (Standard for Collections: A, E, F, K, N, O, S)	0																								
D	Beveled Style Crown Molding (Standard for Collections: G, H, L, V)	0																								
C	Contemporary Style Crown Molding (Standard for Collection: M). This crown molding style is 5/8" taller than the other crown molding styles.	0																								
<b>Door Soft Close Option</b>																										
	Door with Blum® built-in soft close door option.	12 per door																								
<b>Choose Different Decorative Hardware</b>																										
	See page 69.	0																								
<b>Plain Mirror Option</b>																										
	Replace beveled mirror on Premier framed mirrors, framed mirror with lights or tall framed mirrors with plain, non-beveled mirror for a more contemporary look. Available in collections: A, E, F, G, H, L, N, and V.	0																								
<b>Beveled Mirror Option</b>																										
	Replace plain mirror on Premier framed mirrors, framed mirror with lights or tall framed mirrors with beveled mirror. Available in collection: M	25																								
<b>Wood Door Option</b>																										
E,F	Replace Mirrored Door with Wood Door. <ul style="list-style-type: none"> <li>Available for 18" mirrored cabinets (NOT including Breakfront side cabinets) for Premier collections (except Kensington).</li> <li>Available for 12", 15" and 18" mirrored cabinets (including Breakfront side cabinets) for all Molding Overlay collections (E, F, H, M, N).</li> <li>Door styles restricted by Collection offering. Example: Hallmark door style is not offered in Estate Collection.</li> </ul>																									
	Hallmark, Jamestown, Prestige or Shaker Door Style	20																								
	Old Town, Ridgefield or Zenith Door Style	63																								
	Edgewood, Fairfax or Villa Door Style	107																								
<b>Reeded Glass Option</b>																										
G	Replace Beveled Glass Door with Reeded Glass Door. Available on Counter Wall Cabinets and Linen Towers with Glass Door.																									
	Ashford, Gentry, Lambiere & Valencia Collections	70																								
	Estate, Fireside, Heirloom & Nottingham Collections	55																								
	Replace Panel Door with Reeded Glass Door. Available in Toilet Topper.	85																								
<b>Beveled Glass Option</b>																										
	Replace reeded glass with Beveled Glass. Available in Linen Towers and Linen Storage Cabinets with Glass doors.	Subtract 55																								
<b>Door Styles Available but Not Shown on Detail Price Pages</b>																										
We still have most of the door styles that were in the 2008 Catalog, but didn't have enough Price Column space to show them all. You can still purchase the listed Door Style by using the Door Style code and the Price Column listed in your order.																										
	<table border="1"> <thead> <tr> <th>Collection</th> <th>Door Style (Code)</th> <th>Price Column to Use</th> </tr> </thead> <tbody> <tr> <td>Gentry</td> <td>Ridgefield (R)</td> <td>Gentry-Edgewood</td> </tr> <tr> <td>Heirloom</td> <td>Fairfax (F)</td> <td>Heirloom-Edgewood</td> </tr> <tr> <td>Heirloom</td> <td>Lawton (L)</td> <td>Heirloom-Old Town</td> </tr> <tr> <td>Heirloom</td> <td>Prestige (P)</td> <td>Heirloom-Old Town</td> </tr> <tr> <td>Heirloom</td> <td>Villa (V)</td> <td>Heirloom-Edgewood</td> </tr> <tr> <td>Lambiere</td> <td>Prestige (P)</td> <td>Lambiere-Shaker</td> </tr> <tr> <td>Nottingham</td> <td>Ridgefield (R)</td> <td>Nottingham-Edgewood</td> </tr> </tbody> </table>	Collection	Door Style (Code)	Price Column to Use	Gentry	Ridgefield (R)	Gentry-Edgewood	Heirloom	Fairfax (F)	Heirloom-Edgewood	Heirloom	Lawton (L)	Heirloom-Old Town	Heirloom	Prestige (P)	Heirloom-Old Town	Heirloom	Villa (V)	Heirloom-Edgewood	Lambiere	Prestige (P)	Lambiere-Shaker	Nottingham	Ridgefield (R)	Nottingham-Edgewood	
Collection	Door Style (Code)	Price Column to Use																								
Gentry	Ridgefield (R)	Gentry-Edgewood																								
Heirloom	Fairfax (F)	Heirloom-Edgewood																								
Heirloom	Lawton (L)	Heirloom-Old Town																								
Heirloom	Prestige (P)	Heirloom-Old Town																								
Heirloom	Villa (V)	Heirloom-Edgewood																								
Lambiere	Prestige (P)	Lambiere-Shaker																								
Nottingham	Ridgefield (R)	Nottingham-Edgewood																								

# Premier Personal Design Options - Mirrored Cabinets & Lights Options



**A**  
Fly-over  
Light above  
Breakfront  
Mirrored  
Cabinet with  
no lights  
option.



**B**



**C**

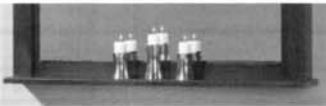

**D**

Ref	Premier Personal Design Option	Custom Option Add-On Price
<b>No Lights on Mirrored Cabinet Option</b>		
A	No lights on mirrored cabinet (false front only).	Subtract 25
<b>No Crown Molding Option</b>		
B	No crown molding on a mirrored cabinet, framed mirror, light, toilet topper or linen cabinet. Not available for Linen Towers.	Subtract 40
<b>No Holes Drilled in Doors and Drawers</b>		
	No holes drilled in doors and drawers and no decorative hardware.	0
<b>Hinge Side Change Option</b>		
C	Change the side of cabinet the door(s) is hinged.	0
<b>Deeper Sill Option for Framed Mirror Shelf</b>		
D	Available on premier framed mirrors and tall framed mirrors. Not available on mitered framed mirrors and on Lambiere & Monterey Collections. Sill is 5 1/2" deep to allow for shelf space.	50
<b>No Sill on Lambiere and Monterey</b>		
	Remove the recessed sill.	0
<b>Unfinished</b>		
Drawer box parts are finished and the interior sides are finished. The base and exterior side of sides are unfinished. Door and drawer standard hardware will be included and doors and drawer fronts will be drilled for hardware. Ordering "Unfinished" cabinetry will void the warranty.		
	For unfinished place a "U" in position 11.	25

# Premier Personal Design Options - Basic Vanity & Dresser Options

Ashford (A) with Shaker (S) door graphics are shown below.

Vanity tops are shown but are not included in the price.

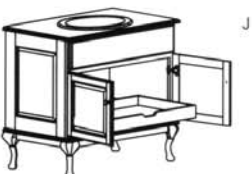
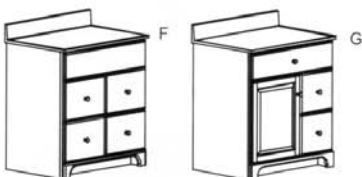
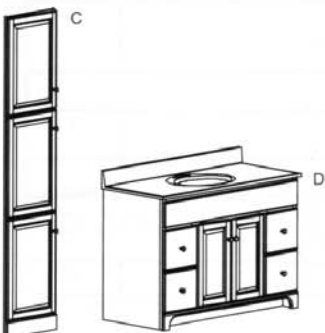
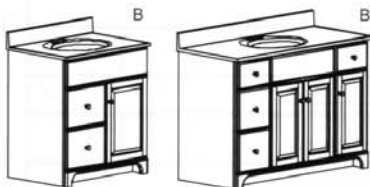

Ref	Description	Custom Option Add-on Price	
<b>Carved On-Lay Option</b>			
	See page 74 for more information (Reference A on page 74).	237	
<b>Hinge Side Change Option</b>			
If the hinge side you require is not available as a model you must order it as one of the following personal design options:			
	Change to Left Side Hinge	0	
A	Change to Right Side Hinge	0	
<b>No Holes Drilled in Doors and Drawers Option</b>			
	No holes drilled in doors and drawers and no decorative hardware. To order decorative hardware separately see page 73.	0	
<b>Door Soft Close Option</b>			
	Door with Blum® built-in soft close door option.	12 per door	
<b>Drawer Soft Close Option</b>			
	Drawer with Blum® full extension drawer glide with built-in soft close option	20 per drawer	
<b>Drawer Stack Side Change Option</b>			
B	Drawer Stack on Left (Available in all single drawer stack vanities)	25	
<b>Linen Cabinet and Vanity Front Only</b>			
C	Face Frame, Doors and False Front (available in non-drawer models). Crown molding and toeboard are not included. For Linen Cabinet Front place "LF" in model number positions 5-6 and for Vanity place "VF" in positions 5-6.	35% Off List	
<b>Full Width False Drawer Front Option</b>			
D	Replace top drawers with a full width false drawer front. For 48" Vanity.	0	
<b>3 False Drawer Fronts Option</b>			
E	Replace top drawers with 3 false drawer fronts. For 54" and 60" vanities.	0	
<b>Stack of Drawers Option (24" and 30" widths only)</b>			
F	Replace a door with a Drawer stack of two drawers.	204	
	Replace a door with a Drawer stack of three drawers.	240	
<b>Drawer to Replace False Drawer Option (Available in 18" or 21" depth)</b>			
G	Replace a False Front with one drawer - 24" - 30" vanity or 36" Molding Overlay vanity only	150	
	Replace a False Front with two drawers - 36" - 48" vanity or 36" Overlay vanity only	216	
<b>RTF 5-Piece Large Drawer Front Look Option</b>			
	The following option may be applied to the Quentin RTF Collection in order to change the standard slab type drawer front style to a 5-piece (Kensington) look. While supplies last.	0	
<b>Bowl Offset to Left or Right Option (Does not apply to Dresser &amp; Open Dresser Vanities)</b>			
	Does not apply to Dresser or Open Dresser Vanities or to Vanities with an F in position 7.		
H	Bowl Offset Left (Available in 48" - 60" vanities)	160	
I	Bowl Offset Right (Available in 48" - 60" vanities)	160	
Bowl center from short end of cabinet is as follows based on design type and Collection code:			
<b>Description</b>	<b>48"</b>	<b>54"</b>	<b>60"</b>
• Overlay Design (A,G,K,L,V)	12"	15"	15"
• Molding Overlay Design (E,F,H,M,N)	13 1/8"	14 5/8"	16"
<b>Dresser Pull-Out Tray Option</b>			
J	Dresser Pull-Out Tray Option with Blum® full extension soft close drawer glides. The location of the drain in the wall is critical and the center of the drain must be located 11" to 13" below the top of the vanity. Available in vanity and dresser models with double doors below the sink. The tray is 3" tall and the top of the tray is 3 3/4" above the base.	150	
<b>End Skin (1/4") Installed Option</b>			
	Specify left, right or both.		
	Vanity, Base, Tall Base Cabinet or Dresser Vanity	124	
	Linen Cabinet - Full (84")	195	
	Linen Cabinet - Partial (54") Left BSSK18L or BSSK21L or Right BSSK18R or BSSK21R	150	
	Counter Wall Cabinet	150	
	Toilet Topper	70	

# Premier Personal Design Options - Custom Width & End Next to Wall Options

Ashford (A) with Prestige (P) door graphics are shown below unless stated otherwise.

Vanity tops are shown but are not included in the price.

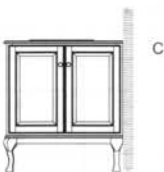
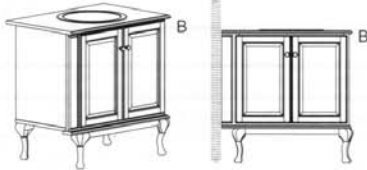

Raised Panel End Examples (Leg or aprons are not included in price of Raised Panel End Option) Shown in Estate (E) with Prestige (P) door drawer style.

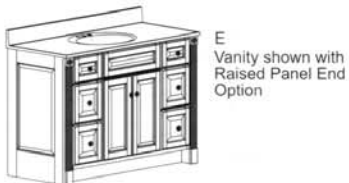

Ref	Description	Custom Option Add-on Price
-----	-------------	----------------------------

## Custom Width using 3" Extended Side Stile Option

We can accommodate your custom vanity, base cabinet, tall base cabinet, counter top cabinet, linen cabinet, dresser, open dresser and linen tower width order as follows: Order the cabinet with the 3" extended side stile(s) option listed below (which can be scribed and cut down to your exact size). Cabinets with personal design options are produced in the same quick cycle as our standard cabinets. The extended stile also includes an extension of the toeboard, skirt and top molding (if applicable). Order the exact custom width vanity top from the Tops Section of the catalog starting on page 271. The extended end will be finished plywood, but will not be stained, painted or glazed.

The consumer or the cabinet installer can scribe and cut the cabinet side stile(s) down to the needed custom width. The Extended Side Stile Option has a 3" extension of skirt and face frame with a vertical false drawer front overlay (shipped unattached) (A, G, K, L, V) and 3" extension of face frame and top molding, if applicable (E, F, H, M, N) except on 5-piece top drawer models.

Note: One door cabinets (like linen cabinets) placed with right end against a wall may require a door side hinge change. However, if not specified the cabinet will be hinged on the left which is standard.

A	Vanity or Base Cabinet - Extend width by 3" on left or right side of face frame (specify Left, Right or Both)	130 per side
	Tall Base or Counter Wall Cab-Extend width by 3" on left or right side of face frame (specify Left, Right or Both)	155 per side
	Linen Cabinet - Extend width by 3" on left or right side of face frame (specify Left, Right or Both)	210 per side
B	Dresser - Extend width by 3" on left or right side of face frame (specify Left, Right or Both)	130 per side
B	Linen Tower - Extend width by 3" on left or right side of face frame (specify Left, Right or Both)	155 per side

## Custom Width using 1/2" Extended Side Stile Option

This option will add 1/2" to the cabinet face frame, stile, toeboard and skirt or top molding where applicable for each end specified. This option should be chosen when a vanity or base cabinet is placed next to a wall in order to center the vanity top bowl. The extended end will be finished but will not be stained, painted or glazed.

A	Vanity or Base Cabinet - Extend by 1/2" on left or right side of face frame (Specify Left, Right or Both)	110 per side
---	---	--------------

## Furniture End Next to Wall Option

	Linen Tower on Base (without Legs) to be placed next to a wall or cabinet (Specify Left, Right or Both).	90 per end
C	Dresser or Linen Tower to be placed next to wall/cabinet (Specify Left, Right or Both). This makes the sill flush with the end. The Ball & Claw and Queen Anne legs will have the front leg replaced with a back leg. The plywood on the end next to the wall will not be stained, painted or glazed.	90 per end
	Open Dresser to be placed next to wall/cabinet (Specify Left, Right or Both).	150 per end

## Skirt Next to Wall/Cabinet Option

	Vanity, Base, Linen Cabinet, Linen Tower or Base Tower (with skirt) to be placed next to a wall or cabinet (Specify Left or Right).	90 per end
--	---	------------

## Crown Molding Next to Wall(s)

D	Crown molding placed next to wall(s) - specify which end(s) are next to wall(s) One door cabinets (like linen cabinets) with right end placed against a wall may require a door side hinge change. However, if not specified the cabinet will be hinged on the left which is standard.	90 per end
---	---	------------

## Raised Panel End Option

For all raised panel end options the panel will be Ridgefield style when Ridgefield or Villa door style is chosen; will be Shaker when Shaker, Edgewood, Fairfax, Old Town or Zenith door styles are chosen and will be Prestige when any other door style is chosen. Not available for vanity models with drawer below doors or Kensington vanities. For Desk Ends you must specify what door style you need to match. Specify Left, Right or Both when ordering with a vanity, base model or desk end. Not available for 24" depth.

E	Vanity, Base or Desk End Raised Panel End	270 per end
	Tall Base Raised Panel End	325 per end

## Plywood End Option

F	Replace Raised Panel End on Dresser Vanity, Base Tower, or Linen Tower with Plywood End. Specify Left end, Right end or Both Ends when ordering with dresser or tower model. Subtract per end.	Subtract per End
	Dresser Vanity (Does not apply to Open Dresser Vanity)	94
	Base Tower	114
	Linen Tower	198

# Premier Personal Design Options - Apron, Skirt, Leg & Misc. Options

Estate (E) with Prestige (P) door drawer style.



Ashford (A) with Prestige (P) door style.

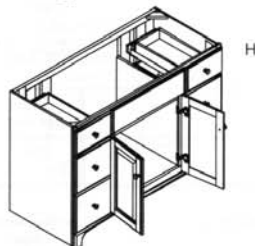
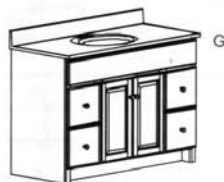
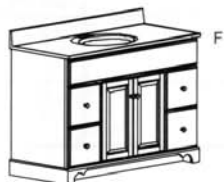
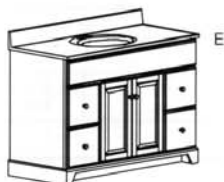
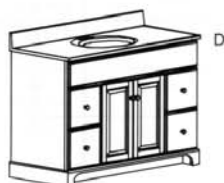

Ref	Description	Custom Option Add-on Price
<b>See Personal Design Option Ordering Information on page 78.</b>		
<b>Front Apron Option</b>		
This option is only available for the Molding Overlay Collections of Estate and Fireside. It is standard on Heirloom, Monterey and Nottingham. It does not change the cabinet height. This design includes a full length toeboard.		
A	Front Apron on Regular Vanity or Linen Cabinet	54
B	Front Apron on large vanity with molding beside sink doors	74
C	Front Apron on Left/Right Breakfront (No Square Legs)	74
D	Front Apron on Breakfront Vanity (No Front Square Legs)	120
E	Front Apron on Breakfront Vanity with Front Square Legs	260
<b>Curved Apron Attached Option</b>		
	Curved Apron to replace standard Apron. Available on Monterey only	0
<b>No Apron Attached Option</b>		
	This option is available only on Heirloom, Monterey and Nottingham Collections.	0
<b>Wrap-Around Skirt or Skirt Change Option on Overlay Collections</b>		
These options are available only for Overlay Collections of Ashford, Gentry, Kensington, Lambiere and Valencia. The wrap-around skirt adds 1" to width. For breakfronts, the skirt does not wrap around the middle front. This option allows you to change the skirt look from your chosen collection (if you choose), PLUS gives you the wrap-around skirt look. Not available for Linen cabinets or Base Cabinets. Must be at least 24" wide.		
The skirt change options allow you to change the skirt look from your chosen collection. This option does not include wrap-around skirt on the ends.		
D	Wrap-Around Ashford (curved) style skirt <sup>1</sup>	110
D	Ashford style (curved) skirt on Front only	60
	Ashford style (curved) skirt on Front only with NO Cut-out	60
E	Wrap-Around Lambiere (angled) style skirt <sup>1</sup>	110
E	Lambiere style (angled) skirt on Front only	60
	Lambiere style (angled) skirt on Front only with NO Cut-out	60
F	Wrap-Around Valencia (scalloped) style skirt <sup>1</sup>	110
F	Valencia style (scalloped) skirt on Front only	60
<b>No Skirt Option on Overlay Collections</b>		
This option is available only for Overlay Collections of Ashford, Gentry, Kensington, Lambiere and Valencia.		
G	Overlay vanity or linen cabinet with no skirt	0
<b>Partitions for Large Vanity Option</b>		
H	Vanity Partitions (of 1/2" plywood) that go on each side of the sink area. For breakfront vanities and all standard vanities in widths of 48", 54" and 60".	90
Notes		
<sup>1</sup> Requires attached end skin option found on page 75.		

# Premier Personal Design Options - Leg & Height Options

Bun

Country French

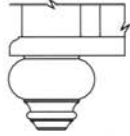
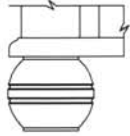

Ashford (A) with Prestige (P) doors shown unless stated otherwise.

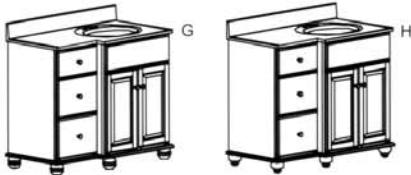
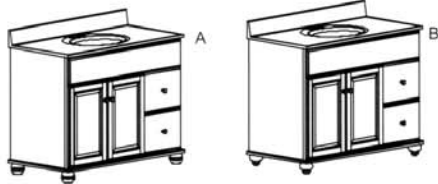

9" Ball & Claw

9" Queen Anne

9" Square Tapered

6 7/8" Square Tapered

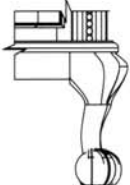

33 1/2"

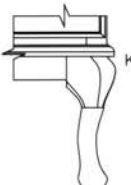

33 1/2"

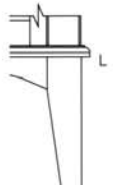

33 1/2"

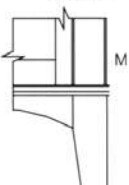

31 3/8"

Dresser vanities, Open Dresser vanities, Linen towers, Base towers and Towel Stands use 9" legs.



Ref	See Personal Design Option Ordering Information on page 78. Description	Custom Option Add-on Price
<b>3" Leg &amp; Sill Option (Bun and Country French Style Choices) 1</b>		
This option is available for vanities, linen cabinets, and linen towers and base towers in all Premier collections. It does not change the cabinet height but adds 1" to the width. The sill is 3/4" high. The legs are 3" high and have a 3 1/2" diameter. Specify "Bun" or "Country French".		
The sill and legs add 1/2" width to each end. Due to this a vanity, linen cabinet or linen tower or base tower with leg options will have a 1" gap above the sill if placed side by side.		
For Hickory cabinets, the Square Tapered leg will be Hickory and for Ball & Claw, Bun, Country French and Queen Anne legs, Oak legs will be substituted.		
A,B	Bun/Country French legs / sill on Regular Vanity up thru 42" or Linen Cab (4 legs)	305
C,D	Bun/Country French legs / sill on Regular Vanity 48" and larger (4 legs)	385
E,F	Bun/Country French legs / sill on Molding Overlay Vanities 48" and larger with extra side molding by sink door - Estate, Fireside, Heirloom, Monterey, Nottingham (6 legs)	480
G,H	Bun/Country French legs / sill on Breakfront Left/Right Vanity (5 legs)	480
I, J	Bun/Country French legs / sill on Breakfront Vanity	575
<b>9" Leg Option for Dresser &amp; Open Dressers, Linen Towers &amp; Base Towers 1</b>		
To choose one of the following options, specify the option on your order.		
The sill and legs add 1/2" width to each end. Due to this a vanity, linen cabinet or linen tower or base tower with leg options will have a 1" gap above the sill if placed side by side.		
For Hickory cabinets, the Square Tapered leg will be Hickory and for Ball & Claw and Queen Anne legs, Oak legs will be substituted.		
J, K	<b>Ball &amp; Claw Leg Option (from Queen Anne).</b> Change from 9" Queen Anne (K) to 9" Ball & Claw (J). For Ashford Collection.	35 per leg
J, L	<b>Ball &amp; Claw Leg Option (from Square Tapered).</b> Change from 9" Square Tapered (L) to 9" Ball & Claw (J). For Gentry, Heirloom, Lambiere and Monterey Collections.	55 per leg
K, J	<b>Queen Anne Leg Option (from Ball &amp; Claw).</b> Change from 9" Ball & Claw (J) to 9" Queen Anne (K). For Estate, Fireside and Nottingham Collections.	Subtract 35 per leg
K, L	<b>Queen Anne Leg Option (from Square Tapered).</b> Change from 9" Square Tapered (L) to 9" Queen Anne (K). For Gentry, Heirloom, Lambiere and Monterey Collections.	20 per leg
L, J	<b>Square Tapered Leg Option (from Ball &amp; Claw).</b> Change from 9" Ball & Claw (J) to 9" Square Tapered Leg (L). For Estate, Fireside and Nottingham Collections.	Subtract 55 per leg
L, K	<b>Square Tapered Leg Option (from Queen Anne).</b> Change from 9" Queen Anne (K) to 9" Square Tapered Leg (L). For Ashford Collection.	Subtract 20 per leg
<b>31 3/8" Height Option on Square Tapered Leg Dresser Vanities 1</b>		
L, M	To change from 33 1/2" tall dresser vanity with 9" square tapered legs (ref. L) to 31 3/8" tall dresser vanity with 6 7/8" tall square tapered legs (ref. M). <b>The most common use for this option is with the taller vessel bowls.</b>	25
<b>Increase Vanity Height by 1" (34 1/2") 1</b>		
This option makes use of a taller toe board and the same base sill that we use for dresser vanities and for the 3" Bun and Country French leg option. For vanities to be mounted next to a wall specify Left End, Right End or Both Ends Next to Wall and add \$90 per End. <b>Not available for multi-piece vanity sets.</b>		
N	<b>Models up to 42"</b>	221
N	<b>Models 48" and larger</b>	298
N	<b>Breakfront Models</b>	398
<b>Increase Vanity Height by 2" (35 1/2") 1</b>		
This option makes use of a taller toe board and the same base sill that we use for dresser vanities and for the 3" Bun and Country French leg option. For vanities to be mounted next to a wall specify Left/Right End Next to Wall and add \$90.		
N	<b>Models up to 42"</b>	230
N	<b>Models 48" and larger</b>	307
N	<b>Breakfront Models</b>	407
Notes 1 Not available for multi-piece vanity sets.		

# Replacement Parts

All Prices listed are for "Each" (quantity of one) unless stated otherwise.  
 Actual Small Package Shipping charges will be added where applicable unless ordered with cabinet order.  
 These items do not count as a piece for quantity discounts.

Description	Model Number	Price
<b>Hinges</b>		
European Style Hinge - Face Frame (pair)	UHBVNHG-	18
European Style Hinge - Frameless (pair)	UHBMCHG-	26
Vanity Knife Hinge (pair) for Signature/Pioneer	UHBVNHG-K <sup>2</sup>	12
<b>Replacement Cabinet Mirrors and Glass</b>		
<b>Premier Collections</b>		
Beveled Mirror for Mirrored Cabinet Door	<sup>2</sup>	29
Beveled Mirror for Mirrored Cabinet Center	<sup>2</sup>	72
Beveled Mirror for Framed Mirror	<sup>2</sup>	88
Non-Beveled Mirror for Framed Mirror	<sup>2</sup>	71
Beveled Glass for Linen Tower & Linen Storage	<sup>2</sup>	58
Reedy Glass for Linen Tower & Linen Storage	<sup>2</sup>	128
Premier Mirror Clips, Glass Clips (Set of 8)	UHBMRCLP	5
<b>Royale - Classic Collections</b>		
Plain Mirror for Mirrored Cabinet Door	<sup>2</sup>	29
Plain Mirror for Mirrored Cabinet Center	<sup>2</sup>	60
Plain Mirror for Tri-View	<sup>2</sup>	35
Classic Mirror Clips (Set of 8)	UHBMRCLP3116	5
<b>Miscellaneous Mirrored Cabinet Hardware</b>		
Premier Shelf Clips - Clear Plastic (Set of 4)	UHBSC16	3
Classic Shelf Clips - Plastic (Set of 4)	UHBSC07	3
Framed Mirror Brackets - (Pair)	UHBBRACKETFM	11
<b>Lighting Parts</b>		
Specify Globe Choice: Bell Crystal, Cone Frosted or Square Frosted.		
Globe	RQGLO-	12
For the following enter finish code after Model Number: Satin Nickel (SN), Brass (BR), Oil-Rubbed Bronze (OB), Chrome (CH).		
Thumb Screws (Set of 3)	UHBTBSC- <sup>1</sup>	2
Decorative Screw Cap (Set of 3)	UHBCLSKNB- <sup>1</sup>	2
<b>Fly-Over Light Parts</b>		
Light Color Ring (Set of 3)	UHBXNRING- <sup>1</sup>	10
Xenon Replacement 20 watt bulb	RQXNBULB20W	20
Xenon Replacement 20 watt bulb with wiring	RQXNPOCKIT-20W	25
Xenon Transformer for three 20 watt bulbs	RQXNTRFRMR-60W	60
Xenon Extension cord for two transformers	RQXEXTCORD	35
Fly-over Filler Strip	UHEFLYFL-	25
<b>Touch-Up Pens and Sticks</b>		
Touch-up pen - specify wood-color	RTTPEN-wood-color code	23
Touch-up stick - specify wood-color	RTTSTK-wood-color code	13
<b>Installation Kits</b>		
3" Vanity Filler (1), 36" Scribe Molding (1) and Touch-up Pen (1) - specify wood-color	BSINSTALL1	140
3" Vanity Filler (2), 36" Scribe Molding (2) and Touch-up Pen (1) - specify wood-color	BSINSTALL2	257
<b>Soft Close Door Hardware</b>		
Soft Close - Molding Overlay & Mirrored	UHBSFCLFM <sup>2</sup>	15
Soft Close - Overlay	UHBSFCLFL <sup>2</sup>	15

Description	Model Number	Finished Price
<b>Cabinet Replacement Parts</b>		
Specify cabinet Item Number plus the door hinge side.		
Mirrored Cabinet or Toilet Topper Shelf and Clips	<sup>2</sup>	50
Linen Cabinet Shelf with clips (1 shelf)	<sup>2</sup>	39
Linen Tower Shelf with Wood Strip and clips (1 shelf)	<sup>2</sup>	60
Tub Enclosure Door Clips (Set of 8)	UHBTLATCH	5
Undermount Drawer Glide 24" Full Extension	RHUNMTSET24-FULL	115
Undermount Drawer Glide 21" Full Extension	RHUNMTSET21-FULL	110
Undermount Drawer Glide 18" Full Extension	RHUNMTSET18-FULL	105
Undermount Drawer Glide 15" Full Extension	RHUNMTSET15-FULL	105
Rear Mounting Bracket for Undermount Drawer Glides (Set of 2)	UHBUNMTBRACKET	10
Front Mounting Bracket for Undermount Drawer Glides (Set of 2)	UHBUNMTLOCK-L/R	10
Vanity Drawer with Glide 3/4 Extension	<sup>2</sup>	150
Vanity Drawer with Glide Full Extension	<sup>2</sup>	175
Pull-out Tray with Glides	UDBO77X <sup>2</sup>	175
Vanity False Drawer Front - 1 piece	<sup>2</sup>	2 per 1"
Vanity False Drawer Front - 5 piece	<sup>2</sup>	8 per 1"
Toe Board (Maximum length 78") Premier (5" Tall)	<sup>2</sup>	2 per 1"
Toe Board (Maximum length 78") Royale/Classic/Builder (3" Tall)	<sup>2</sup>	1.50 per 1"
Cabinet Door - L, O, P, S, Z	<sup>2</sup>	80
Cabinet Door - E, F, R, V	<sup>2</sup>	122
Cabinet Door with Plain Mirror	<sup>2</sup>	80
Cabinet Door with Beveled Mirror/Glass	<sup>2</sup>	137
Cabinet Door with Beveled Mirror / Bead Edge	<sup>2</sup>	177
Cabinet Door with Beveled Mirror/Reed Glass	<sup>2</sup>	247
Linen Cabinet, Linen Tower, Base Tower Door - Single L, O, P, S, Z	<sup>2</sup>	99
Linen Cabinet, Linen Tower, Base Tower Door - Single E, F, R, V	<sup>2</sup>	140
Linen Cab End Skin Top 54" (1/4" thick ply)	BSSKA <sup>2</sup>	100
Linen Utility Door-Bottom L, O, P, S, Z	<sup>2</sup>	200
Linen Utility Door-Bottom E, F, R, V	<sup>2</sup>	281
Poly Bumper Pads for Doors & Drawers (12)	UHBPADFOAM	2
Vanity End Skin 33 1/2 H x 20 1/4 D (1/4" thick plywood)	BSSK <sup>2</sup>	77
Vanity End Skin 33 1/2 H x 23 1/4 D (1/4" thick plywood)	BSSK <sup>2</sup>	85
Linen Cabinet End Skin 84" tall(1/4" thick ply)	BSSKA <sup>2</sup>	120
Linen Cabinet End Skin 54" tall(1/4" thick ply)	BSSKA <sup>2</sup>	100
Counter Wall Cab End Skin 47 1/2" tall (1/4" thick ply)	BSSKS <sup>2</sup>	80
Toilet Topper End Skin 32 1/8 H x 21 D (1/4" thick ply)	BSSKTT-A- <sup>2</sup>	35
Roll-out Hamper for lin. cab. (15 W x 21 1/2 H x 19 1/2 D)	RHHAMP-SET	195
Plastic Hamper only (14 1/2 W x 19 5/8 H x 19 1/2 D)	RHHAMP	115
<b>Filler Strip Between Linen Cabinet and Vanity Top</b>		
For illustration and dimensions see Vanity Tops Price List		
Linen Cabinet/Vanity Top Filler Strip	BSFS21 or 18 <sup>3</sup>	18
<b>Furniture Legs <sup>3</sup></b>		
3" Bun Leg	RUL3BUN- -	72
3" Country French Leg	RUL3CRFNH	72
9" Tall Ball and Claw Leg -Front	RUL9CLWFT	107
9" Tall Ball and Claw Leg - Back	RUL9CLWBK	107
9" Queen Anne Leg - Front	RUL9QANF	102
9" Queen Anne Leg - Back	RUL9QANS	102
9" Square Tapered Leg	RUL9SQTPD	75

<b>Notes &amp; Exceptions</b>		
1 SN-Satin Nickel, BR-Brass, OB-Oil-Rubbed Bronze CH-Chrome		
2 Specify model number and wood-color (if applicable).		
3 Specify wood and if finished, specify wood-color.		

• Replacement Doors and Drawers will NOT be drilled for decorative hardware.